

PERSPECTIVE VIEW

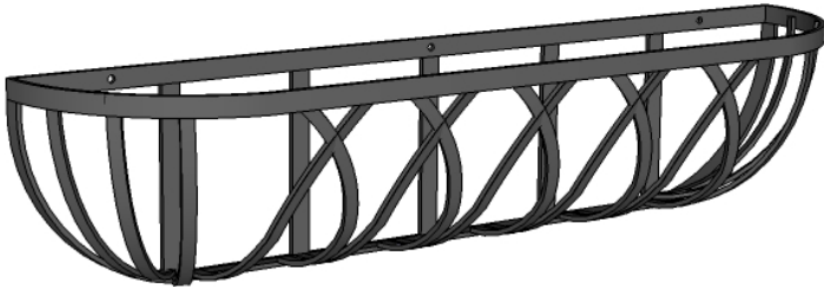

BACK VIEW

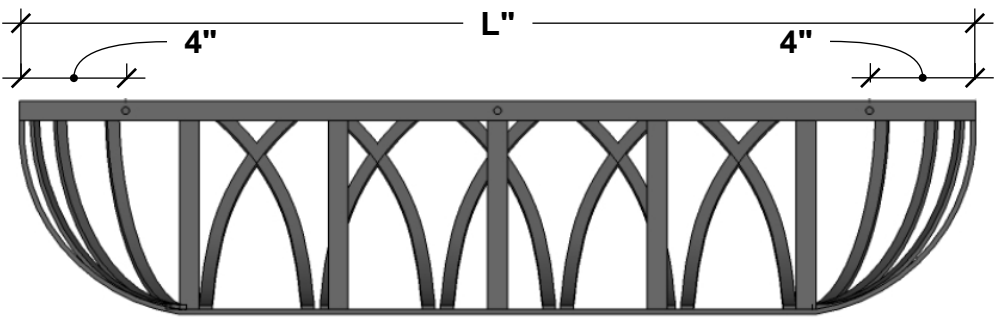

SIDE VIEW

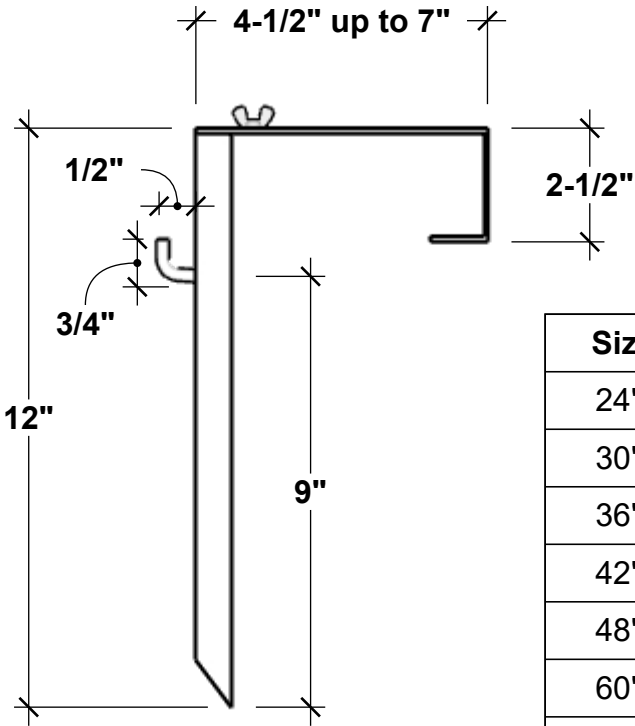
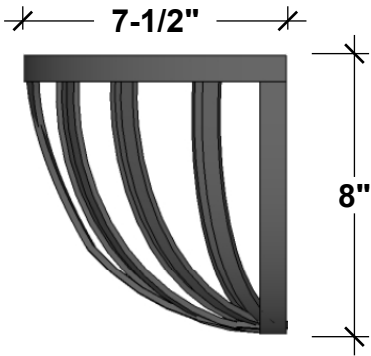

Size
24"
30"
36"
42"
48"
60"
72"

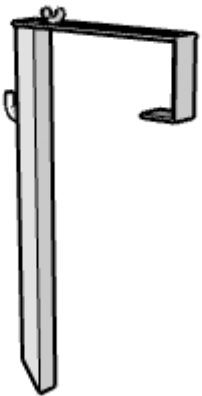

GENERAL NOTES
1. Frame and Back vertical supports are 0.75" x 0.1875" Flat Bar 2. Front Supports: 0.5" W x 0.1875" Thk Flat Bar 3. Back Vertical Supports are 6" apart on center 4. Comes with Coco Liner
1. Railing bracket come in pairs 2. Wrought iron material is black vinyl coated 3. Made to fit 2x4 or 2x6 wood railings. 4. Simply hang the bracket on the wood railing, and adjust and tighten the screws for a secure fit. 5. Hang the window basket by setting the back flat bar inside "L" Shaped hook and hang a hayrack trough or window basket with ease on a 2x4 or 2x6 rail. No hardware necessary. 6. Two pairs for window boxes in 60 and 72 inches in length. Smaller sizes come with one pair of railing brackets. 7. Half inch space to place the back bar of hayracks or window box cages to fit securely in the L-shape of the bracket. 3/4" deep/tall

HOOKS & LATTICE

A CARLSBAD MANUFACTURING COMPANY

1 (800) 896-0978

HooksandLattice.com

PRODUCT DESCRIPTION				SKU				PREPARED FOR		APPROVAL SIGNATURE
ARCH HAYRACK RAILING PLANTER - FOR WOOD RAILINGS				506B-X-L-72885						
DIMENSIONS	MATERIAL	COLOR / FINISH	REP	DB	DATE	REV	ORDER #	PROJECT / SIDEMARK / IF#		APPROVAL DATE
			Cressa	RM	02/2025					

PLEASE NOTE: Due to the handmade nature of our products, individual measurements may vary from those listed. The provided dimensions are for reference only
All images are the intellectual property of Hooks and Lattice. Reproduction in any form is strictly prohibitive without the express written permission of Hooks and Lattice. All designs are property of Hooks and Lattice.