

FRONT VIEW

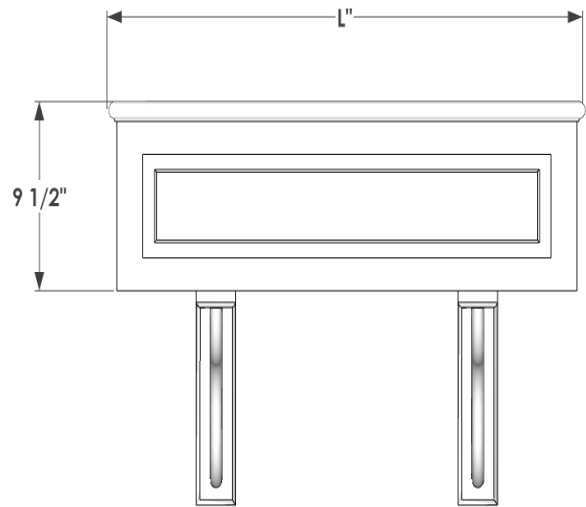

SIDE VIEW

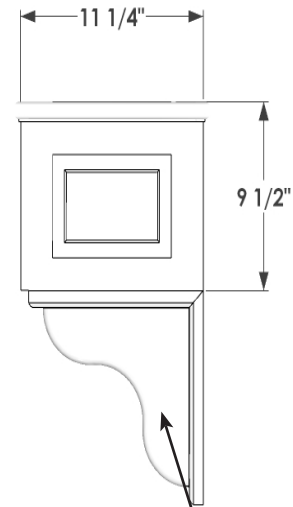

L SIZE
24"
30"
36"
48"
60"
72"

BACK VIEW

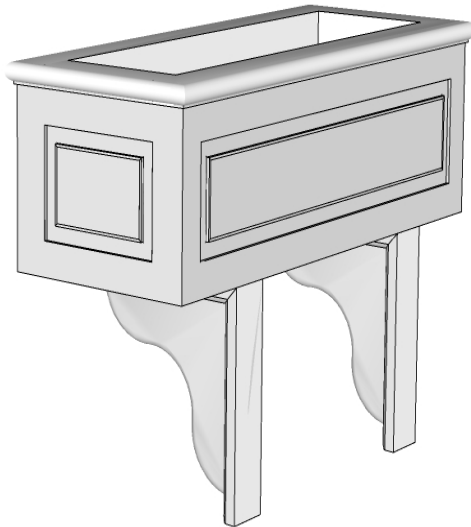

Pair of Brackets (2 pairs for 60" and 72" lengths)

**GENERAL NOTES**

1. Shelf Mount Brackets are Required for Wall Mounting Applications
2. Framed style : W0-TRAD 24"-36" has 1 raised panel, 48"-72" has 2 raised panels

 <b>HOOKS &amp; LATTICE</b> 6056 Corte Del Cedro, Carlsbad CA 92011 1-888-320-0626/service@plantersunlimited.com www.plantersunlimited.com	<b>PRODUCT DESCRIPTION</b>		<b>SKU</b>		<b>ORDER NUMBER</b>	<b>CUSTOMER SIGNATURE</b>
	Framed Panel Cedar Planter		W1-FPC			
	<b>DIMENSIONS</b>	<b>COLOR</b>	<b>FINISH</b>	<b>REP:</b>	<b>DB:</b>	<b>DATE</b>
	Natural Cedar					

